

REV F Change to .750x.190x.062W 6/15/15 GRH

To Set Preload In Vertical Axle #1: **Be Certain #25 Springs Are Installed.** Seat Upper Nut #21 Fully & Install Cotter Pin. Tighten Lower Nut #21 Slowly until All Freeplay of Springs #25 is Removed and Fork #12 No Longer Rotates Freely. Loosen Lower Nut # 21 2-3 Locking Features and Install Cotter Pin. Fork Should Pivot Freely Around Complete Rotation

CONFIGURATION NOTE:Units made after 8/07 use the #17 TWBL which uses #26 grease fitting MSCMC7-4, #1 .625-18x4.35 Vertical Axle, 3 #2 TW-19, and #18 TW-4 washer.

Units made before 8/07 use #17 TWB (no grease fitting provision), #1 .625-18x4BOLT(A), 2 #2 TW-19, and #18 TW-2 washer

Alternate Wing Available to Provide Earlier Steering Release. Part number T-03A
Release with Standard T-03 = $\pm 45^\circ$
Release with T-03A = $\pm 25^\circ$

T-03A May Be Hand Ground to Angles between $\pm 25^\circ$ & $\pm 50^\circ$

NO.	PART NAME	INVENTORY NO.	REQ'D
1	BOLT, DRILLED	SEE CONFIGURATION NOTE	1
2	BUSHING	TW-19	2
3	COTTER PIN ZINC	.11X1.5COTTERPIN	2
4	SPACER, TAIL WHEEL	BSP4	2
5	BOLT	AN3-6	2
6	WASHER	AN960-10	4
7	NYLON WASHER	.750X.190X.062WASHER	2
8	WING, TAIL WHEEL	T-03 **See Note on Alternate**	2
9	CASTLE NUT	AN310-3	2
10	SHCS	.25-20X.50SHCS	1
11	SHCS (AXLE)	.50-13X3.50SHCS	1
12	FORK, 6" TAIL WHEEL	TW-6F	1
13	BUSHING	P406-WD(KIT)	2
14	BEARING	P406-WD(KIT)	2
15	TAIL WHEEL 6" COMPOSITE	P406-WD(KIT)	1
16	WASHER	.625SAE	2
17	BASE, TAIL WHEEL	SEE CONFIGURATION NOTE	1
18	BUSHING, BRZ	SEE CONFIGURATION NOTE	1
19	ARM, TAIL WHEEL	T-02	1
20	BUSHING BRZ	TW-21	1
21	HEX NUT SLOTTED	.62-18HEXNUT/SLOTTED	2
22	NYLOC NUT	.50-13NYLOC	1
23	COTTER PIN ZINC	.062X.50COTTERPIN	2

26	FITTING, GREASE	SEE CONFIGURATION NOTE	1
25	CURVED SPRING WASHER	U625-0210	2
24	BELLVILLE WASHER	B0375-020	2

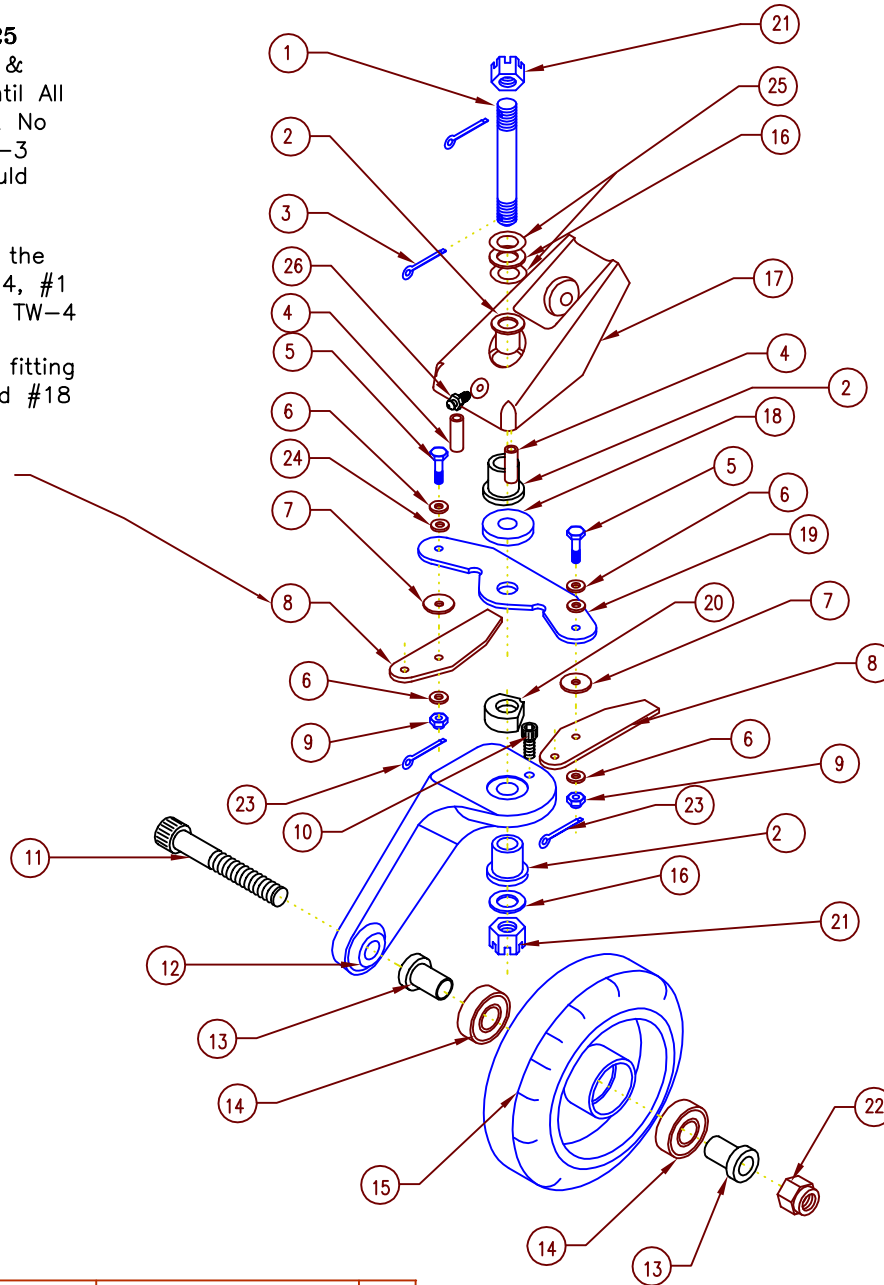

T8.DWG

2361 S 1560 West
WOODS CROSS, UT 84087 (801) 335-0582

T6

DRAWN BY: GARY P. LANGFORD
CHECKED BY:

SCALE: NONE
DATE: JULY 21, 1993

REVISION:
F